



WAVERLEY COMMUNITY
MEN'S SHED INC.

SCUTTLEBUTT

WCMS MEMBERS' NEWSLETTER

Patron - The Hon. Marjorie O'Neill MP, Member for Coogee

Volume 5 Issue 7

JULY 2024

Editor: Tom Wolf <newslettereditor@waverleycommunitymensshed.org.au>

Website: <http://waverleycommunitymensshed.org.au>

All photographs and articles published remain the copyright property of the contributor and WCMS unless released. Some articles are researched from internet material and no copyright infringement is intended

IF YOU ARE NOT WELL, YOU ARE NOT WELCOME AT THE SHED!

*It's our 11th Anniversary,
so, let's Party at the
Shed, on*



Wednesday, 24 July at 12:30pm

**Bring your plate of food, or make a \$25 contribution
and we'll do the buying (see Michael Barker)**



We have all heard of **Lifeline** and have seen the lifeline telephone number on the TV when the news reader has shown or described some awful event, but how many of us know exactly what it does

and how it does it?

Lifeline have now opened an **office in Bondi Junction** and we have organised a presentation from two of the people from there to help us understand what it is and potentially invite us to join their list of volunteers. One of the volunteers in the Bondi office is a retired fellow a bit like us, it will be a very interesting presentation.

The presentation will be held in the **War Memorial Hospital's Education Centre** on **Monday 12th August** just after lunch at **12.30** for about an hour including questions.

Come along, it will be well worth your time

PARIS 2024



26 JULY - 11 AUGUST

GO AUSSIES!!



PRESIDENT'S BLOG

The major event last month was the hanging on each machine a list of members names certified to use that machine. Next comes the problem of officially certifying members to use machines that they may have considered they were able to use.

Peter Black is planning a series of training days, probably on a Thursday, when there will be three trainers each taking three members on three machines through a training session. Enrolling on these training sessions will be on a first come first served basis, so if you want to gain Certification, watch for the announcement on the white board of the course details and be quick to put your name on the list.

On Wednesday 22nd May, we hosted a visit from the Parramatta Men's Shed. Our visitors came for morning tea and we had a good chat. Parramatta Men's Shed is located in a long series of rooms that allow them the luxury of being able to have a metal working room, a couple of woodwork rooms, a high tech room with laser engraver and 3D printer etc as well as a large meeting room. Oh how we wish we had a bigger Shed!!

At a previous visit to Parramatta, I was able to see how their certification process works and learnt about their morning gathering at which they all discuss improvements to the Shed, safety issues and plans for the future. It is difficult for us to have a similar meeting in that we don't have a big enough meeting area, and we all seem to arrive at different times during the morning.

In May, we had a meeting with Carolyn Yeow who is the Project Manager for the Uniting site development. She showed us one of the layout drawings they are considering for the ground floor area that could become a Men's Shed area. We saw that the two small store rooms could present a problem but also saw how useful the proposed shared meeting area might be. The shared meeting area will provide room for us to all be in the same area for meetings, lunch and morning tea, even if we have a little saw dust and a few shavings on our person.

Our wood shed has been a mess for some time but on the Friday after the Board meeting a group of volunteers came to clean it. Many thanks to those who came in, they filled to its capacity our big green bin, even though it did not look full as it was packed carefully, so as to use almost the whole volume. There was a very effective chain of members; Ian Dawes picked out the pieces, assisted by Sid Lewinsky, who passed them out to the team of Mo Dhanoya, Graham Carthew, Peter Charlton and Peter Black, who cut the pieces into the right size to be fitted into the three dimensional jig-saw puzzle (the green bin) by Peter Robilliard.



Peter

Uniting

Uniting War Memorial Hospital

invites you to a free seminar on

HANDS and FEET

Monday 1st July, 12.30pm to 2.30pm

- Common hand and foot problems in older people
- Looking after your hands and feet
- Treatment of common conditions

War Memorial Hospital Day Centre, 125 Birrell St Waverley

Entry from 12pm, light lunch will be provided.

Bookings essential: Catriona 93690215

or hakieu.truong@health.nsw.gov.au





SHED GOINGS-ON (CURRENT PROJECTS ETC.)



Nick Tyrrell has completed the construction of his "**Bird Hilton**", a luxury home for birds, thoughtfully designed and with no expenses (or effort) spared in bringing it into being. Nick describes it as having 1

bedroom; 1 living room; 1 kitchen; 1 bathroom; 1 car park and 1 TV room and suggests a sale price of \$4M for this luxury birdhouse worthy of being on Mayfair, but we are not sure if our box of Monopoly contains that much currency.



An inventive design!! **Pierre Carrion** has made a **coat hanger board** (left)



Mo Dhanoya is making a 1940's style **wooden toy car** (right)



New to the Shed, **Jim Savvas** is oiling the **chopping boards** that he has making (left)



Craig Rubenstein is turning a **burl bowl** (right) ... (now say that after a few stiff drinks!)



Steve Weymouth is making a very distinctive **trefoil street library box** for the Bondi Girl Guides for their hall in Thomas Hogan Reserve (left)



Sid Lewinsky's wooden **candelabra/chanukiah** is finished (right)



Peter Black's team is repairing a **kitchen sink with taps** etc for St. Mary's Child Care Centre in Waverley, . (left)



Peter Robilliard and **Graham Carthew** painting possum boxes made for WIRES (right),

cont. p.4

cont. from p.3



Rodney Goldberg is helping **Harry Jacobs** with making a **table-top** (left). For his age (not to be disclosed as it is over 90), Harry is one of the most active Sheddors at Waverley.

Harry Jacobs is also making a **key rack** with a small shelf on the top (right)



Rodger Jamieson is making a **small table**. Construction is finished and Rodger is just staining it (left)

HE'S BACK! Just to prove that you can't keep good men down, whilst still recovering from his recent hospitalisation with a broken femur, **William Honeyball** has started back at the Shed. Here he is instructing **Sid Lewinsky** on the proper use of the **SawStop** (right)



Tom Wolf is running activities at both Mark Moran Vacluse and Montefiore Homes Randwick for the nursing home residents, who paint and assemble **wooden toy cars and Kokeshi dolls** created at the Shed. here **Jeff Silberbach** is turning the dolls (left), while **Mo Dhanoya and Mike Weiher** are cutting wheels for the cars (right)



Spring must be around the corner as **Graham Ely** is restoring a set of **garden chairs** (left)

Tom Wolf is making a **1:30 scale model yacht** for a Mark Moran Vacluse resident (right). He has been assisted by **Richard Cortis** who made the **pedestal stands**.



Often the real work carried out by Committee members goes un-noticed and unacknowledged. One of the most thankless tasks is the role of the **Treasurer**. Since his appointment to the role, **Charles Gerrard** has worked ceaselessly and has had very little time to do any projects. **WE ARE ALL GRATEFUL CHARLES!**



DO YOU LIVE IN A DAMP HOUSE?

By Richard Cortis

It is now winter in Sydney and it is the time of year for sniffles and sneezes and perhaps some signs of mould and dampness at home. Before you rush off to complain about the mould on the ceiling and the damp odour in the house or unit, there are several housekeeping measures that are low cost and may actually eliminate the problem at no cost. Open the door and the windows and let the wind to blow through the house to dry out the condensed moisture on the ceiling, walls and in the carpet as well as other areas of your home. This moisture accumulates as a result of your normal occupation of the house or unit because you breathe, cook, shower, and sometimes sweat a bit. It is preferable to ventilate daily but if this is impractical, do it as often as you can.

When you live in a house or unit, normal occupation generates moisture which condenses on surfaces within the residence. You may see little black or grey spots of mould on the ceiling or walls, typically in corners and other places where there is little air movement. This is a strong indication that some damp control measures are needed.

As suggested, the simplest approach to control condensation dampness is to open the doors and windows to let the wind blow through and carry away the condensed moisture. Ventilation is normal good housekeeping. It is also effective and low cost.

In addition to regular ventilation, there are a few other things you can do. Check out the function of the ceiling exhaust fan in the bathroom and the laundry. If it runs but does not hold up a paper face tissue, it is probably not doing much to remove humid air.

It may surprise you that many exhaust fans do not work because there is no functional outlet from the ceiling space. Check out exhaust fans to see if they actually provide any useful function. If you have condensate mould issues in the bathroom, try opening the window to let the steam out before it condenses.

A hard technology treatment is to install a heated towel rail. Nice warm fluffy towels but the small amount of heat generated tends to discourage condensation and associated mould growth. But ventilation remains essential to mould control.

You may get damp in the bedroom, typically on the ceiling and in corners. Most people breathe out about a litre of water overnight which contributes to condensation and mould growth.

Bedrooms also tend to suffer more from condensation because, in winter, people tend to heat the living room but not the bedrooms. In this case, normal heat convection may carry moist air from the living areas into the unheated bedroom where it can be expected to condense.

Do you get condensation on the inside of the bedroom windows overnight? Open the window a but so long as you do not freeze, and let the wind blow through in the morning to remove the condensed moisture.

In chronically damp houses and units, the carpet can become a significant health hazard as, being on the floor, it tends to be cooler than other surfaces and necessarily tends to accumulate condensed moisture.

We all bring home little sniffles and sneezes which our immune system usually controls quite nicely. However, the output from those coughs and sneezes tends to drop into the carpet where it can accumulate and breed. There is then potential for these bugs to overload our immune system, causing us to get sick. It then become likely that a cycle of illness may develop unless steps are taken to control the damp in the carpet



cont. p.6

cont. from p.5

Sick carpet syndrome? Open the door and window and let the wind to blow through to evaporate the moisture in the carpet and break the cycle.

If you have been suffering from what you believe to be dampness in your home, one step that may assist in breaking the cycle is to have the carpet steam cleaned as this vacuum treatment is likely to remove some of the carpet contaminants adversely affecting your health.

After the treatment you will need to open the doors and windows to let the wind blow through to remove the residual moisture from the steam cleaning. You should continue to ventilate to remove accumulated moisture in the future.

Wardrobes tend to suffer some mould growth, particularly if the doors are kept closed. Leather shoes and leather jackets tend to suffer mould growth more than other garments. The appearance of mould on natural leather garments may indicate the need to ventilate your wardrobe, particularly if it is a built-in unit against an external wall.

The exterior wall will tend to be colder than the bedroom and the cold back wall will enhance moisture condensation with associated mould growth. Minor mould growth on leather garments and shoes may be inevitable because they are difficult to launder. Running a fan with the doors open may help in reducing minor wardrobe damp issues. More severe wardrobe dampness associated with a cold exterior southern wall may need a small (about 15 watt) heater to control condensing moisture.

The discussion so far has assumed that the dampness is the result of condensation of normal humidity in the home. If there is rain water penetration or leakage of water from the bathroom, kitchen or laundry, **specific specialist advice may be required.**

In the meantime, open the doors and windows to let the wind blow through and remove condensed moisture.



FOUR PETERS, ... PLUS ONE?

Peter Charlton, Peter Black,
Peter Ulmer and Peter

Robilliard demonstrate "relaxation in action", photo by Peter Chapman

This is why you never call out "Hey, Peter, toss me a hammer" at the Waverley Shed ...

You are likely to have more than one tossed to (or is it at?) you at the same time.

Just as well Pierre Carrion wasn't there at the time?



BRAINFREEZE

Teamwork!!



JIGS AND FIXTURES

THIS IS A REPRINTED ARTICLE FROM AN EARLIER ISSUE WRITTEN BY CLIF MUNRO, BUT JUST AS RELEVANT TODAY.

I often hear '*...I'm not a tradesman, nor even much of a handyman ...*' so this month's Techie Tips is for newbies.

Jigs and fixtures are things to help make life easier while making something - especially at home.



Simply put- a **Jig** is a device which guides the tool, while a **fixture** is a device that securely holds the job in position while you do something

If all you have is a battery drill, a tenon saw and some F-clamps, here are a few simple ones to get you started.

SQUARE DRILLING JIG

Nail together a couple of 38mm x 19mm scrap pieces about 80mm long to form a right angle as shown. It's important to make everything true and square. For a more robust jig, add some glue to the joint. When the jig wears out, make another one.

To use: Position the drill bit tight into the corner of the jig as shown and drill your hole.



BENCH HOOK

A **bench hook** minimizes the need for a vice or clamps and allows you to make quick cuts while protecting the worktop. You can use this on any surface with a square edge or even a stair tread if you don't have a work bench.

To make this simple bench hook find a plank or scrap ply at least 16mm thick for the **platform** and determine how long you'd like it to be. A suggested size is 300mm long by 240mm wide but go with what you have to hand.

Cut the 38mm by 19mm **hook piece** at the bottom to the width of the **platform** and the **top fence** about 25mm shorter than the platform width. Next, fasten them together with wood glue to opposite ends of the platform as shown in the picture. This allows for the bench hook to secure to the front edge of your work surface.

To use: Put the bench hook on the worktop, place the timber to be cut against the top fence, lean forward and use the palm of your hand to hold the workpiece in place as you cut.

Safety tip: Keep your thumb **away from the saw blade**

CORNER CLAMP FIXTURE



This handy little fixture is self-explanatory in layout and uses any timber offcuts with square ends.

Make them in pairs with holes to suit your F-clamps. Mark out the position of the two holes and cut with a suitable **holesaw**.

If you don't have a holesaw you can use a **spade bit** but first drill a 6mm **pilot hole** using your **square drilling jig**.

The spade bit will follow the drilled pilot hole through the material. Make sure you **firmly clamp** the workpiece to a worktop. **Don't** force the spade bit through the timber and hold the drill firmly

Finally, you can cut the diagonal by clamping to the top fence on your newly made **bench hook**.

I hope you will find these helpful additions to your tool kit. If you need to ask anything email me at <waverleyshed@gmail.com>.

Clif



CURRENT SCAMS, BEWARE!!:

There are lots of scams to be aware of, these are just a few:

Customers are warned to be aware of fake emails claiming to be from **Australia Post**. This email might look real, but Australia Post will never call, text or email asking for personal or financial information, including passwords, credit card details or account information, or to request a payment



Parcel Delivery Coordination: Urgent Address Review Needed

Dear Valued Customer,

We regret to inform you that our courier was unable to complete the delivery of your package due to an incorrect or undeliverable address.

As a result, the parcel has been safely returned to our depot.

To ensure a seamless delivery experience, we kindly request you take a moment to provide us with an updated address using the button below. This will enable us to schedule a new delivery attempt promptly.

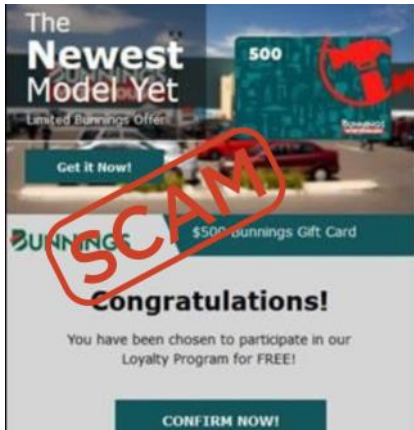

Be warned if you receive an email purporting to be from Bunnings and offering a \$500 gift card. This is a scam, so do **not click on the link** and report the phishing email to Scamwatch.

If you receive a text from what appears to be **myGov** claiming your tax refund has been automatically processed - **don't fall for it, ignore, delete, and block.** The ATO will never send you a link to log in to online services by text message. These are particularly common at financial year's end

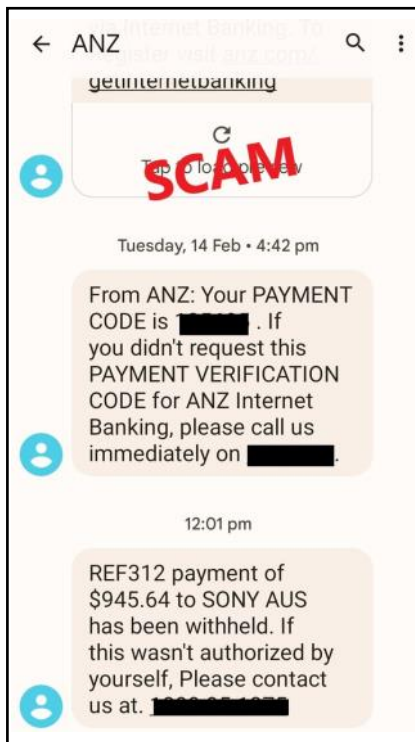

Watch out for **bank impersonation** text messages stating a payment has been authorised and prompting you to call a number if it wasn't you. **Never call a number** sent to you in text or email, always search your bank's real number yourself.

There is a huge rise in the infamous "**family hoax**" scams which include fake messages from "Mum" or "Dad" or children. These requests use the ruse of a lost or broken phone, a lost wallet, or having the wrong card with the justification that the funds are needed because the family member can't access their online banking temporarily,

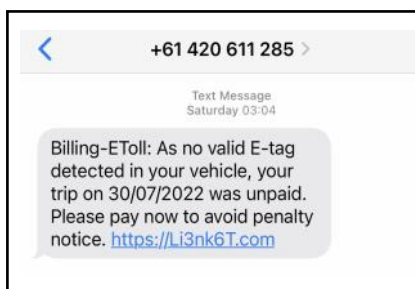
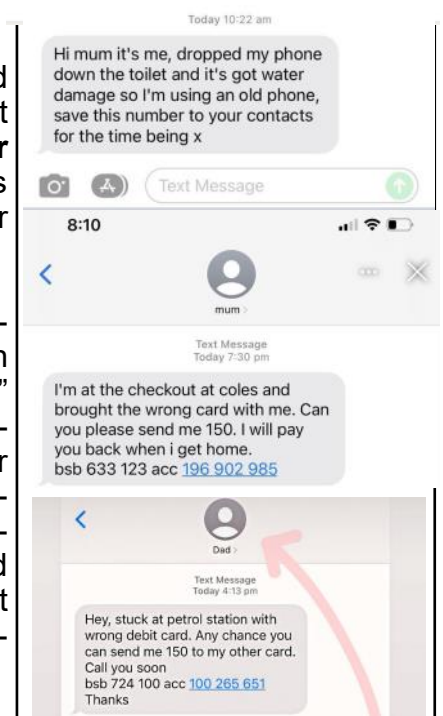

Drivers are being warned not to fall for a scam text relating to **road tolls**. The text, which comes from a random mobile number, warns people they have not paid a toll. When you click the link it takes you to a website which is likely to steal your information if you enter details.



PROJECT IDEA: BILLYCART

As kids we aspired to get one and considered ourselves "the king of the block" if we had one.

So, why not build one for your grandchildren? Ask a social group (like scouts or your church group) if they would like to use a few at their picnic? Or even organise a race between teams of kids (including your grandchildren) at the local park?

The Nepean Shed have been making billycarts for years, racing about in billycarts is an enduring childhood experience.

This article is not about how to make one, as there are lots of plans and instructions for how to



make one available on the internet, it is rather just to motivate and to plant an idea into the minds of those who may be interested in making one!

You're not losing your memory. You're just really good at letting go of the past!

MURPHY'S OTHER LAWS

1. Light travels faster than sound. This is why some people appear bright until you hear them speak.
2. A fine is a tax for doing wrong. A tax is a fine for doing well.
3. He who laughs last, thinks slowest.
4. A day without sunshine is like, well, night.
5. Change is inevitable, except from a vending machine.
6. Those who live by the sword get shot by those who don't.
7. The 50-50-90 rule: Anytime you have a 50-50 chance of getting something right, there's a 90% probability you'll get it wrong.
8. It is said that if you line up all the cars in the world end-to-end, someone from Florida would be stupid enough to try to pass them.
9. If the shoe fits, get another one just like it.
10. The things that come to those who wait, may be the things left by those who got there first.
11. Give a man a fish and he will eat for a day. Teach a man to fish and he will sit in a boat all day drinking beer.
12. Flashlight: A case for holding dead batteries.
13. God gave you toes as a device for finding furniture in the dark.
14. When you go into court, you are putting yourself in the hands of twelve people, who weren't smart enough to get out of jury duty.



A man went to see his doctor because he was suffering from a miserable cold. His doctor prescribed some pills, but they didn't help.

On his next visit the doctor gave him a shot, but that didn't do any good, either.

On his third visit the doctor told the man to go home and take a hot bath. As soon as he was finished bathing he was to throw open all the windows and stand in the draft.

"But doc," protested the patient, "if I do that, I'll get pneumonia."

"I know," said his physician, "I can cure pneumonia."



DACH'S TUGBOAT MODEL AT MMV

mark moran
VAUCLUSE

Dach Hall, an Honourary Member of the Waverley Men's Shed, is a resident of **Mark Moran Vaocluse** (MMV), a retirement village and nursing home situated in Vaocluse.

Dach and **Tom Wolf** run an Annexe to the Waverley Shed at MMV, they greet residents of MMV, socialise, and are always available for a refreshing cup of coffee/tea and a discussion about anything and everything so as to fill the residents' day and make them feel good.

They also run a small workshop provided by the owners of the village, where they carry out various repair projects for all the residents, and where they also conduct a modelling workshop making (predominantly) wooden ship models.

Alan Rubel from the Waverley Shed brought along a severely damaged ship model and gifted it to Tom, indicating that he would be pleased if Tom would arrange for the model to be repaired. The model was that of **St. Canute** made by Billings Boats, the model is superseded and no longer being made, and for which no instructions are available from Billings on the Net.

The model of **St. Canute** is scaled 1:50 and is 560mm long, it is a model of a vessel built in 1931 at the Frederikshavn Shipyard in Denmark. She operated for many years as a tugboat and icebreaker in the Odense harbour under its original name of **St. Knud**.

The problem with lack of plans and instructions was solved by one of Tom's international friends from USA who found an old copy which was then colour printed by **Tod Thomson**.

Dach completed the repairs, the results will be seen in the accompanying photos. The finished model was shown at the "**Sydney Festival of Model Ships**" and received much praise.

The model is now placed on display at the Village for all the residents to enjoy.



CORTIS TRAVEL ADVISORY

Trawling through old email, we found this little beauty from **Richard Cortis** from 2020 when he visited a temple in Vientiane, Laos.

It leaves nothing to the imagination and is the kind of signage we have all experienced during our travels in South-East Asia.

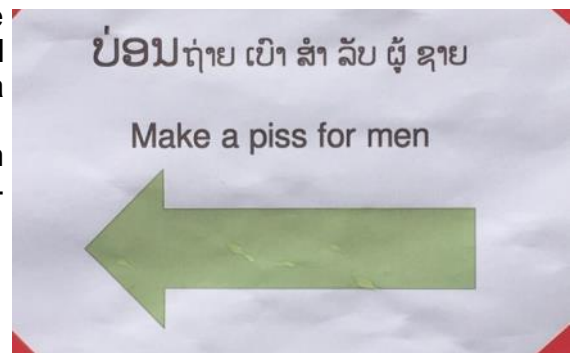



IDEA FOR A NICE DAY OUT: BARE ISLAND FORT

Creative Commons



Mentioned in the journals of both Joseph Banks and James Cook, Bare Island sits at the northern entrance to Botany Bay at La Perouse, a suburb of Sydney.

Banks collected shell specimens there, while Cook noted that the island described as "a small bare island", a name that stuck.

In his journal "A Voyage to New South Wales", William Bradley relates that in July 1788 noticeboards were erected on the island to advise visiting ships that the settlement had moved to Port Jackson.

With the outbreak of hostilities between Russia and Britain in 1876 (the Crimean War), Australian colonies started realising how defenceless they were against enemy raids and started thinking of fortifying the coastline.

To protect Sydney's "back door", construction of Bare Island Fort was completed in 1885, the connecting bridge added in 1887, and barracks were built inside the Fort in 1889.

Bare Island Fort reflects the development of coastal fortifications design by the British Army from locations around the world over more than a century. With a newly generated understanding of ballistics and materials, Bare Island, in comparison to earlier coastal defences constructed in Sydney such as Fort Denison or the Middle Head Batteries, shows the impact of new materials such as concrete, as well as the ever-increasing power of guns. Indeed the fatal flaw in the Fort was that incorrect concreting was used, resulting in a Royal Commission and the sacking of both the government official overseeing the project, and the builder.

By the early 1900's the Fort came to be recognised as unnecessary, and was decommissioned and converted into a war veteran's home (except during WW2 when it was again used for military purposes).

The island became a public reserve in 1965 and became a Historic Site in 1967, the Fort was made into a museum.





TOOL & TRADIE T-SHIRTS

We have enjoyed seeing some interesting T-shirts over the years, we actually have a rule against wearing offensive garments at the Waverley Shed. It is hoped that these will so offend you as to send us some more!!.

